

MV500/15

Three phase-4poles-1500RPM-50HZ 230/400 Voltage

Mechanical Features			Electric Features		
General			General		
Working moment	40.12	kg.cm	Nominal voltage	Δ:230V	Y:400V
Unbalance	20.06	kg.cm	Input power	0.35KW	
Force	504	kg	Current A max	Δ:1.84A	Y:1.06A
Bearing			Power factor	0.61	
TYPE	6306		La/in	2.8	
	100%	7378	Certification		
Life(h)	80%	14412	ETL CLASS II DIV.II	T4	
	50%	59034	GROUP F G TENV NEMA 4		
Bearing Grease			IP65		
Lube Schedule			Amb Temp. (-20°~+40°)		
Lube replacement					
Grease Type					

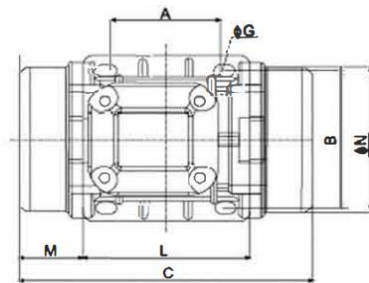
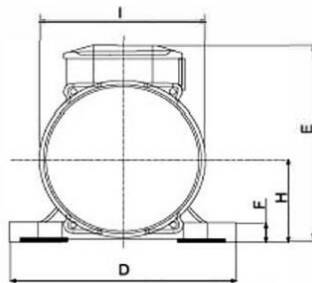

A	105
B	140
C	334
M	78
G	13
Holes	4
D	168
E	196
F	22
H	92
I	169
L	178
N	158

Clamping torque(Nm) 80

weight	Screw	washer	Cable type	Cable Glande
21	M12	13X24	4GX2.5	M20X1.5